



NOTICE OF TIMBER FOR SALE

A BID OPENING WILL BE HELD AT THE OFFICE OF LEGACY FOREST MANAGEMENT

122 E. OAK ST. SPARTA, WI 54565 (608) 633-2288 eric@legacyforestmanagement.com

INSTRUCTIONS FOR SUBMITTING BIDS:

1. Submit bids only on the bid sheet associated with each timber sale.
2. Upon notification of an accepted bid, bidder must submit a performance bond equal to 10% of the total bid amount within six weeks of notification. Checks should be payable to Legacy Forest Management and will be held by the forester on behalf of the landowner. Irrevocable letters of credit will be accepted. The letter of credit must have an expiration date 6 months beyond the contract deadline, landowner's name as the beneficiary and dollar amount.
3. Successful bidders will be expected to sign a timber sale contract and issue the specified down payment amount within 21 days of notification of the winning bid.
4. Failure to sign the timber sale contract, submit a performance bond, and issue down payment within the required time frame will result in being removed from consideration on future sales.
5. An original certificate of worker's compensation and commercial general liability coverage is required for all sales and must be provided with the signed timber sale contract upon acceptance of the bid.
6. Bidders are encouraged to inspect the quality and quantity of each sale before they submit a bid.
7. Our intent to accept the highest responsible bid; however, the landowner reserves the right to reject any or all bids.
8. The locations, building, and maintenance of landings, roads and accesses are the full responsibility of the purchaser and are subject to advance approval of the forester and landowner. The forester must be contacted at least 48 hours prior to construction of a landing, road or access. Purchaser is responsible for reseedling of roads, skid trails and landing areas post-harvest if performed when the ground is not 100% snow covered.

Please feel free to call with any questions related to the sale(s).

TIMBER SALE #104 ALECKSON

Acres: 16

Location: T19N R07W S28 PT NWNW, PT SWNW (Town of Gale) Trempealeau Co. WI

Property Address: W13887 State Highway 54 Ettrick, WI

SALE TYPE: SCALED SALE

A ticket system will be used to track all loads of wood products leaving the sale. Landing tickets must be matched to the corresponding Mill/Scale tickets weekly. Each load will be deducted from the estimated volume for each species/product category. All wood must be paid for prior to leaving the property. Payments in excess of the total will be refunded as part of the harvest closeout procedure.

TIMBER QUALITY: Size and quality are above average for this sale. Several quarter-saw sized White Oak and Red Oak.

TIMBER SALE VOLUME ESTIMATE: Products marked for harvest include veneer, sawlogs, & bolts.

Species	Sawtimber Volume (MBF Scribner Dec. C.) 12"+ DBH
Red Oak	14.29
White Oak	11.27
Misc. Hardwoods	3.66
TOTALS	29.22 MBF

*Misc. Hardwoods include: Black Oak (.99), Elm (.78), Cherry (.73), Soft Maple (.47), Basswood (.35), Aspen (.34, & Hickory (.10)

SALE DESCRIPTION: Sale boundaries are marked with blue paint & ribbon. All merchantable Ash, Aspen, White Birch, and Elm & Hackberry within the harvest areas are considered to be cut trees. Patch clearcut areas are encircled with vertical orange paint stripes on the interior of the clearcut area. Throughout the harvest area there are individually marked trees with horizontal orange paint stripes. Care must be taken to minimize damage to residual timber. An area located near the highlines has been flagged with pink ribbon, this area can be clearcut to provide additional room for landing space.

Access. The sale area has good year-round access. Located along State Highway 54 additional landing space will likely need to be created by opening space north of the highline on top of the hill. The landing will need to be cleaned up post-harvest once all products have been hauled.

Soil Conditions: Silt Loam, deep rich soils.

Hunting Restrictions: No hunting restrictions in place for this sale.

CONTRACT PERIOD: 24 MONTHS

Restrictions:

1. Oak Wilt. No logging operations will be allowed between April 1st and July 15th each year.
2. Soil Restrictions. Logging and hauling will only be allowed when ground conditions are dry or frozen so that rutting and excessive soil compaction will not occur.

CUTTING PRESCRIPTION:

1. Cut all stems greater than 10" dbh within the patch clearcut areas.
2. Cut all individually marked trees within the harvest area, marked with orange paint stripes.
3. Utilization will be expected of any designated tree containing at least one stick (8'6") with a small end diameter of 8 inches.

PAYMENT SCHEDULE:

1. 10% down payment will be required on estimated bid amount upon contract signing.
2. 90% advanced stumpage payment will be required prior to the start of logging.
3. Final: a financial reconciliation will occur after site is closed out to determine if a refund is due to the timber buyer or if a final payment is due to the seller.
4. All wood products must be paid for before leaving the landing.

PURCHASER REQUIREMENTS:

1. Purchaser and contractors must meet with the forester prior to moving equipment on site.
2. All existing trails & haul roads must be left back-bladed smooth and cleared of debris following completion of cutting, skidding & hauling.
3. If harvesting stops for more than two weeks or if the contractor removes equipment from the site, the trails must be repaired as best as possible to pre-harvest conditions prior to leaving.
4. All products must be hauled within 45 days of cutting unless otherwise agreed upon prior to the start of cutting.
5. No large debris will be allowed to be left on landing sites once harvesting and hauling have been completed.
6. All slash must be left in the woods and cut to a minimum of (8') from the ground.
7. Cut offs must be pushed back into the woods from the landing areas.

ADDITIONAL INFORMATION:

1. The sale area is located on moderately sloped terrain with some steep but short slopes located throughout the harvest area. It appears that little to no dozer work will be required to complete the sale.
2. Late Summer/Fall or Winter harvesting should be expected. If weather permits, late summer logging might be possible, but soil conditions must allow for non-rutting conditions.

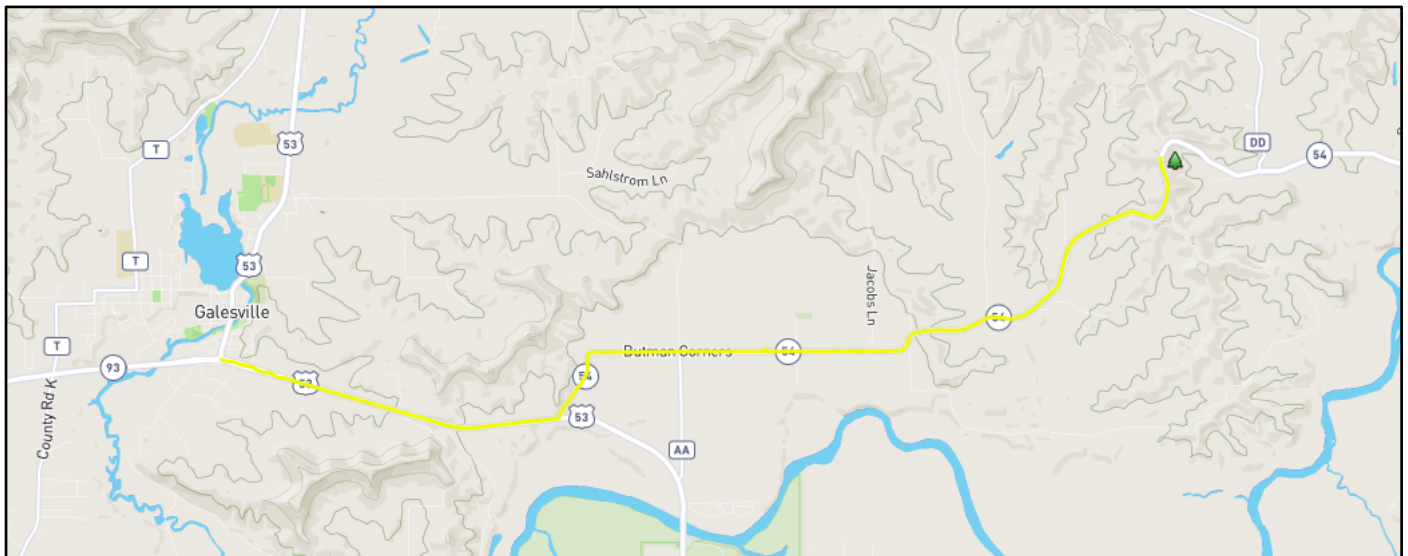
Location Map

Sale Location: From Galesville, WI head east on US Highway 53, turn left (Northeast) on State Highway 54. Follow Highway 54 for 5 miles. Park at the highlines on the east side of the road to view the property.

Sale Map

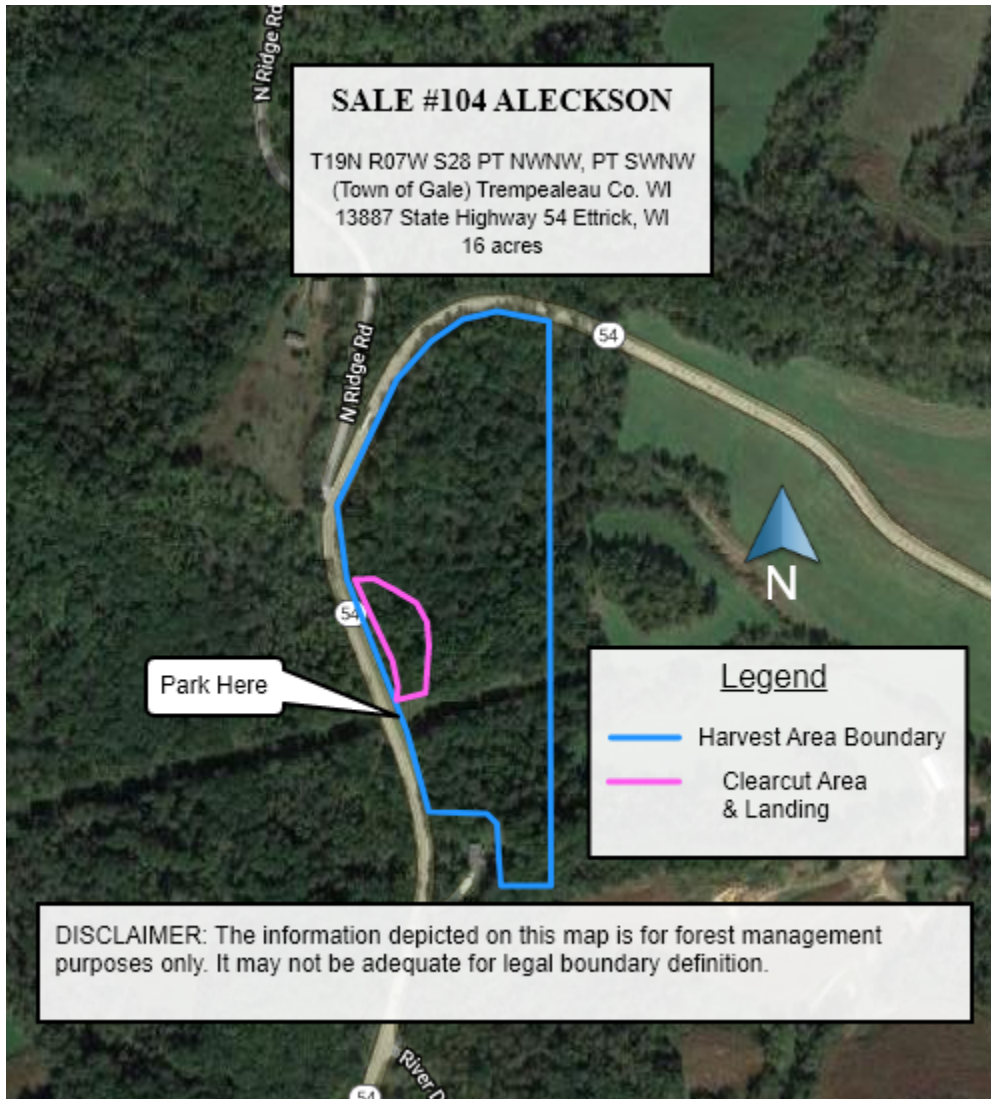

Access to the sale area: Will be via State Highway 54. Access the sale area will be at the highline right of way, park here to view the sale.

Please submit this form with your bid along with your business card.

TIMBER SALE #104
LANDOWNER: ALECKSON
SALE TYPE: SCALED SALE

T19N R07W S28 PT NWNW, PT SWNW (Town of Gale) Trempealeau Co. WI

Company Name: _____ Phone: _____

Buyer: _____ E-mail: _____

Bid Worksheet

Species	Estimated Volume	\$/unit	Total
Red Oak	14.29	/mbf	\$
White Oak	11.27	/mbf	\$
Misc. Hardwoods	3.66	/mbf	\$
TOTALS	MBF LOGS CORDS BOLTS		\$

MBF = 1,000 board feet

Bid Amount: _____

Estimated bid amount is based on cruise volumes. Actual amount paid will be determined by Mill scale.

Performance Bond: _____

= Total Bid x 10%

Winning bidder must submit a check or irrevocable letter of credit equal to 10% of the bid amount as a performance bond within six weeks of bid acceptance. Checks should be made payable to LEGACY FOREST MANAGEMENT. Irrevocable letters of credit will be accepted but must have an expiration date at least six months beyond the contract deadline, landowner's name as the beneficiary and dollar amount. Legacy Forest Management will hold the performance bond on behalf of the landowner until the terms of the contract have been met. Performance bonds will NOT be deducted from final stumpage payments. A check (or letter of credit) will be returned to the purchaser within 30 days of the terms of the contract being met and a final inspection of the sale by the forester and landowner.